



SPCO
makes life easier



Sewage

Submersible Pumps,
60Hz

Approvals

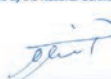
		CB TEST CERTIFICATE	Ref. Certificate No. CH-8875
IEC SYSTEM FOR MUTUAL RECOGNITION OF TEST CERTIFICATES FOR ELECTRICAL EQUIPMENT (IECEE) CB SCHEME			
Issued by:	Electrosuisse		
Product:	Submersible pumps		
Applicant:	Swiss Pump Company AG	Moosweg 36 CH-3645 Gwatt (Thun)	Switzerland
Manufacturer:	Swiss Pump Company AG	Moosweg 36 CH-3645 Gwatt (Thun)	Switzerland
Factory:	Swiss Pump Company AG	Moosweg 36 CH-3645 Gwatt (Thun)	Switzerland
Rating and principal characteristics:	220-240V~, 50/60Hz 3 x 220V~, 50/60Hz 3 x 400V~, 50/60Hz 3 x 480V~, 50/60Hz Power range: 0.37-30kW class I, IP68		
Trade mark (if any):	Swiss Pump Company AG (SPCO)		
Model/Type reference:	UG, QF, Sewage (0.37-30kW) see appendix type list in test report		
Additional information:	—		
Sample of product tested to be in conformity with IEC:	60335-1(ed.4)am1.am2 60335-2-41(ed.3)am1.am2	National differences: EU Group Differences; EU Special National Conditions; EU A-Deviations	
Test Report Ref. No.:	06-HG-0208.01 + .02 + .03 + .06		
This CB Test Certificate is issued by the National Certification Body:			
Electrosuisse Luppenstrasse 1, CH-6320 Fehraltorf			
Signed by:	Erich Obrist		
	2010-07-27	page 1 of 1	



THE INTERNATIONAL CERTIFICATION NETWORK

CERTIFICATE

IQNet and SQS
hereby certify that the organisation

Swiss Pump Company AG
3645 Thun-Gwatt
Switzerland

Certified area
Whole company

Field of activity
Manufacture and sale of products for the transportation of liquids

has implemented and maintains a
Management System
which fulfills the requirements of the following standard(s)

ISO 9001:2008

Scope No(s): 17, 18, 19
 Issued on: 2015-03-03
 Validity date: 2018-03-02
 Registration Number: **CH-32160**



Michael Drechsel
President of IQNet



Roland Glauser
CEO SQS



IQNet Partners*:
 AENOR Spain APNOR Certification France AIB-Vincotte International Belgium ANCE-SIGE Mexico APCER Portugal CCC Cyprus
 CIBO Italy CQC China CQM China CQS Czech Republic Cio Cert Croatia DQS Holding GmbH Germany
 FCAV Brazil FONDORAMA Venezuela ICONTEC Colombia IMNC Mexico Inspector Certification Finland IRAM Argentina
 JQA Japan KQ Korea METEC Greece MSZT Hungary Nemko AS Norway NSI Ireland PCBC Poland
 Quality Austria Austria RR Russia SII Israel SIQ Slovenia SRIM QAS International Malaysia
 SQS Switzerland SRAC Romania TEST St Petersburg Russia TSE Turkey YUQS Serbia
 IQNet is represented in the USA by APNOR Certification, CSQ, IQPS Holding GmbH and NSAI Inc.
 * The list of IQNet partners is valid at the time of issue of this certificate. Updated information is available under www.iqnet-certification.com



Contents

NEB Series	page	4
NEB • NEBR Series		6
NEBS Series		8
NE Series		10
NA Series		12
NC Series		14
NW Series		16
GPK Series		18
NSA Series		20
MAM Series		22
MAL Series		24

NEB Series • Construction Dewatering Pumps

Features

- High abrasive resistance resin Vortex impeller.
- Stainless steel outer case & strainer.
- SST 410 motor shaft.
- Double mechanical seal.
- High cooling effect & long-lasting running.

Applications

- Residential, Commercial.
- Industrial dewatering and site drainage.
- Construction sites.
- Civil engineering projects.



NEB-5.20~30



NEB-5.50~75



NEB-5.100~150

Performance Curves

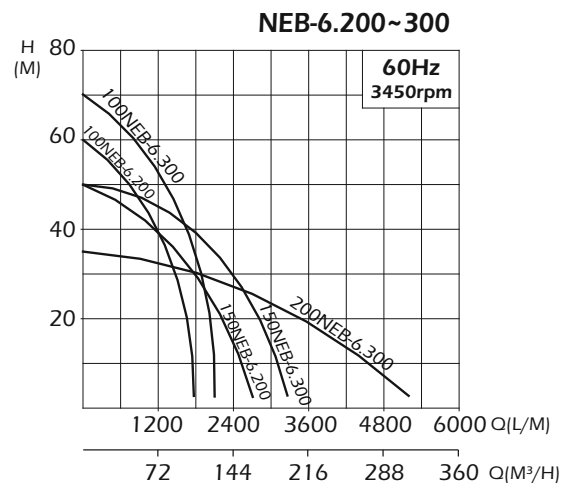
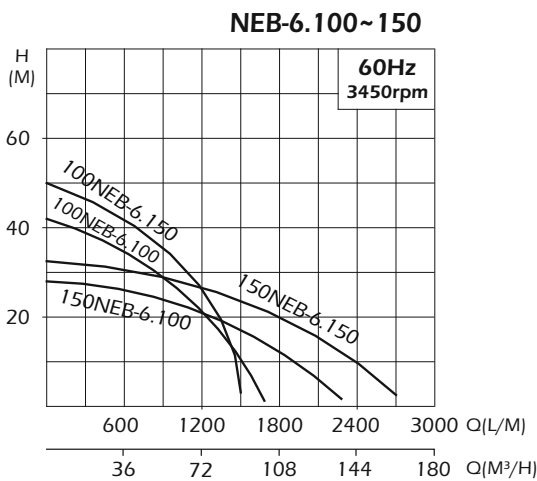
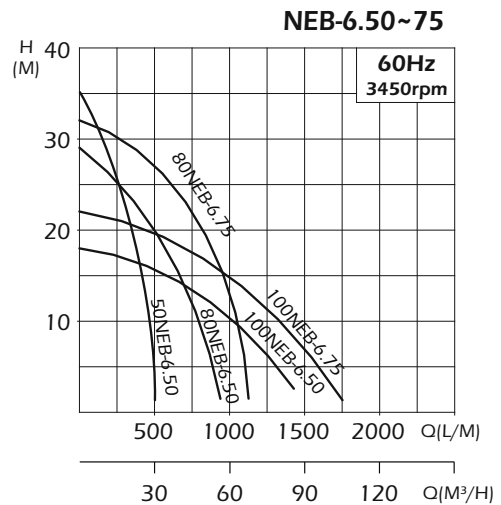
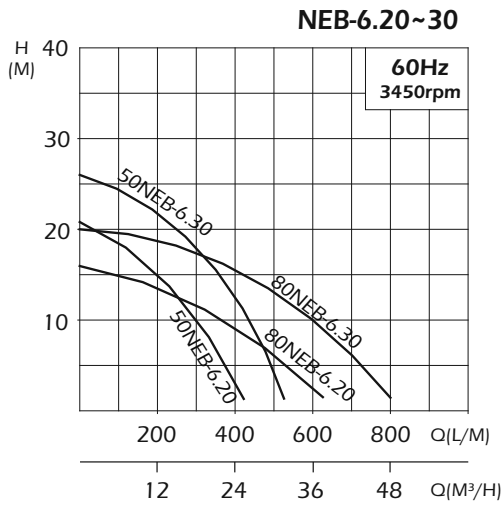

• All technical information is subject to change without notice.

Specification

Type	Output		Discharge		Rated		Maximum		Solid Pass mm	Weight Kg
	HP	KW	Inch	mm	Head M	Capacity LPM	Max Head M	Max Capacity LPM		
50NEB-6.20	2	1.5	2"	50	14	250	21	430	9	34
80NEB-6.20	2	1.5	3"	80	8	500	16	620	9	34
50NEB-6.30	3	2.2	2"	50	18	300	27	560	9	36
80NEB-6.30	3	2.2	3"	80	10	600	20.5	800	9	36
50NEB-6.50	5	3.7	2"	50	30	200	36	500	10	45
80NEB-6.50	5	3.7	3"	80	20	500	30	900	10	45
100NEB-6.50	5	3.7	4"	100	10	1000	18	1440	10	45
80NEB-6.75	7.5	5.5	3"	80	25	500	32	1200	10	50
100NEB-6.75	7.5	5.5	4"	100	15	1000	24	1600	10	50
100NEB-6.100	10	7.5	4"	100	30	800	42	1600	15	86
150NEB-6.100	10	7.5	6"	150	15	1600	28	2250	15	86
100NEB-6.150	15	11	4"	100	35	1000	51	1550	15	93
150NEB-6.150	15	11	6"	150	20	1700	32	2550	15	93
100NEB-6.200	20	15	4"	100	45	1000	60	1700	15	141
150NEB-6.200	20	15	6"	150	35	1500	50	2500	15	142
100NEB-6.300	30	22.5	4"	100	60	1000	70	2000	15	256
150NEB-6.300	30	22.5	6"	150	35	2000	50	3200	20	259
200NEB-6.300	30	22.5	8"	200	26	2900	35	5200	20	264

Dimensions(mm) and Material list

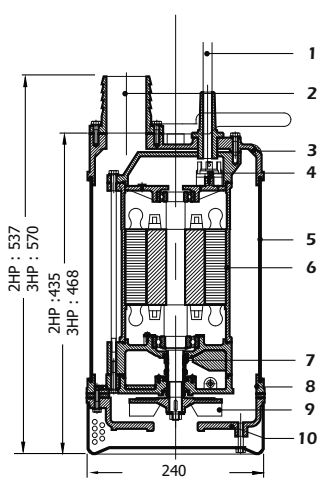

NEB-5.20~30

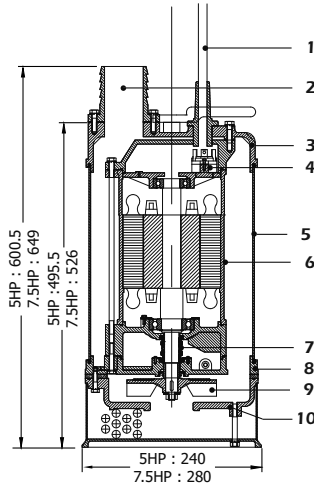

NEB-5.50~75

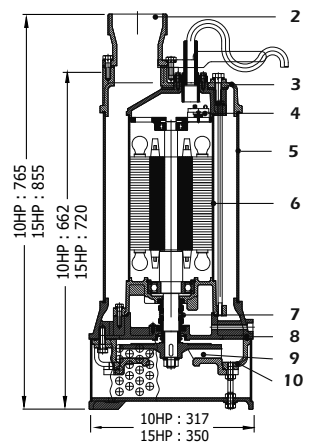

NEB-5.100~150

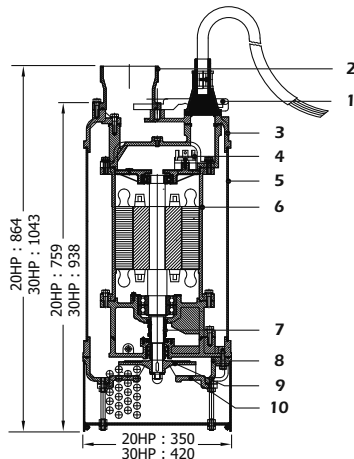

NEB-5.200~300

No.	Part	Material
1	Handle	Steel
2	Discharge outlet	Cast Iron
3	Top cover	Cast Iron
4	Protector	
5	Outer case	SS-304
6	Motor casing	SS-304
7	Mech. Seal	CA/CE+SIC/SIC
8	Volute	NBR (2HP~7.5HP) Cast Iron (15HP~30HP)
9	Impeller	High Chrome Steel
10	Inlet plate	Cast Iron

NEB • NEBR • Submersible Dewatering Pumps

Features

- High abrasive resistance resin Vortex impeller.
- Double mechanical seal.
- Auto reset thermal protector.
- Compact design & Lightweight.
- Oil free motor & SS 410 motor Shaft.

Applications

- Residential, commercial, industrial dewatering and site drainage.
- Construction sites and civil engineering projects.
- Basement, parking lots, removing residue water (NEBR).



NEB-6.05 ~6.10



NEBR-6.05 ~6.10

Performance Curves

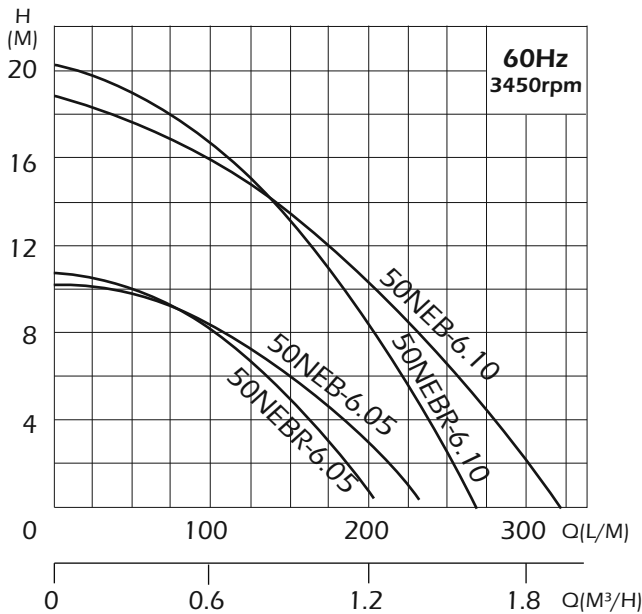

Hytrel Impeller

Specification

Type	Output		Discharge		Rated		Maximum		Weight Kg
	HP	W	Inch	mm	Head M	Capacity LPM	Head M	Capacity LPM	
50NEB-6.05	0.5	400	2"	50	8	120	10	232	13
50NEBR-6.05	0.5	400	2"	50	8	120	11	204	12
50NEB-6.10	1	750	2"	50	10	180	19	317	16
50NEBR-6.10	1	750	2"	50	10	180	20	264	15

All technical information is subject to change without notice.

Dimensions

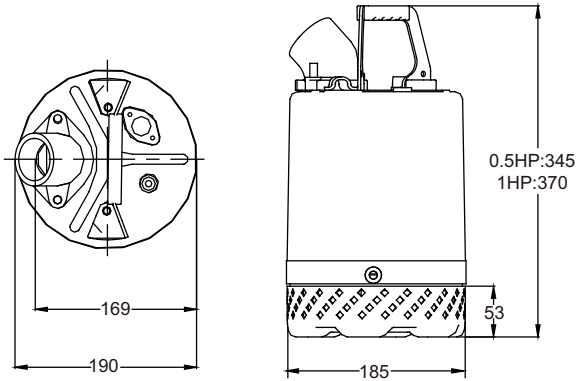

50NEB-6.05 ~6.10

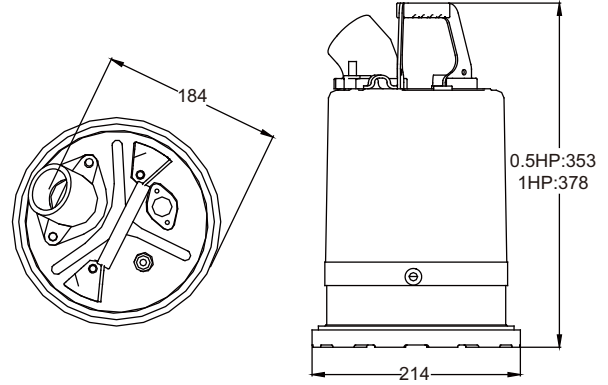

50NEBR-6.05 ~6.10

NEB • Parts and Material list

No.	Part	Material
1	Handle	SS400
2	Motor cover	ADC12
3	Out cover	SS304
4	Capacitor	
5	Stator	
6	Motor housing	ADC12
7	Shaft & Rotor	SS 410
8	Seal casing	ADC12
9	Strainer	SS 304
10	Pump housing	Cast Iron
11	Impeller	Hytrell
12	Packing	NBR
13	Mechanical Seal	SIC/SIC
14	Lower bearing	
15	Upper bearing	
16	Motor bracket	Ss400

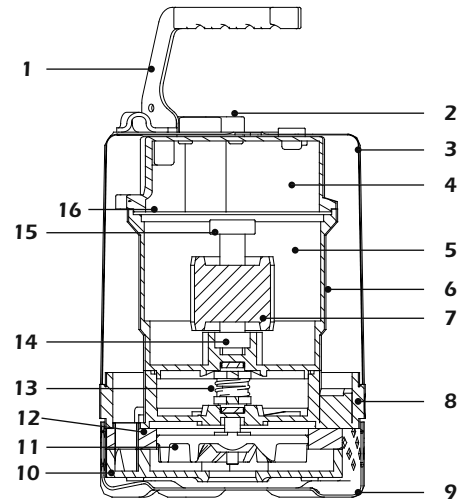

NEBR • Parts and Material list

No.	Part	Material
1	Handle	SS400
2	Motor cover	ADC12
3	Out cover	SS 304
4	Capacitor	
5	Stator	
6	Motor housing	ADC12
7	Shaft & Rotor	SS 410
8	Seal casing	ADC12
9	Pump base	NBR
10	Pump housing	Cast Iron
11	Impeller	Hytrell
12	Packing	NBR
13	Mechanical Seal	SIC/SIC
14	Lower bearing	
15	Upper bearing	
16	Motor bracket	SS400

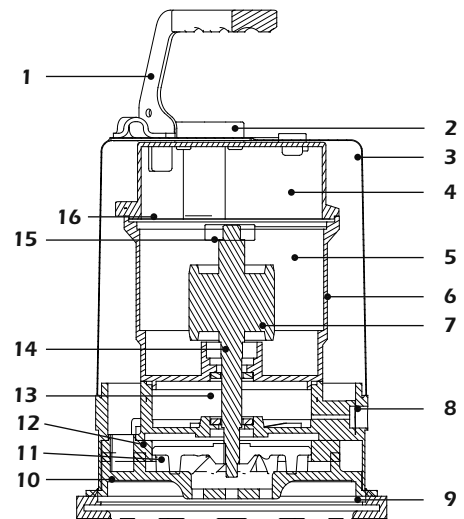

NEBS • Submersible Dewatering Pumps

Features

- Constructed entirely in stainless steel: motor cover, motor frame, impeller...all in stainless steel. All surface materials and oil are non-toxic.
- Heat-treated 410 stainless steel shaft.
- Double mechanical seal
lower : silicon carbide/ silicon carbide.
upper : carbon/ ceramic.
- Oil-free motor, 1 & 3 phase, with thermal and over-current protector.
- Class F insulation, IP 68 protection motor.
- Tethered float switch is available upon request.



NEBS-6.05

NEBS-6.10

Applications

- Utility, Telecommunications, Power generation plans, Drainage of construction sites & Civil engineering projects

Performance Curves

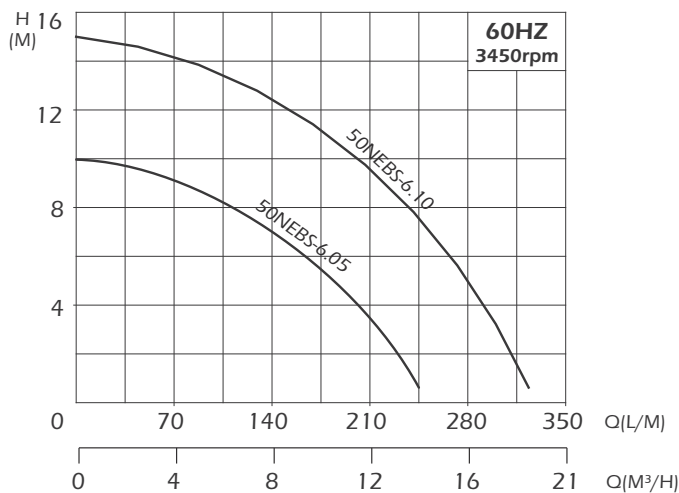

Specification

Type	Output		Discharge		Rated		Maximum		Solid pass mm	Weight Kg
	HP	KW	Inch	mm	Head M	Capacity LPM	Max Head m	Max Capacity l/min		
50NEBS-6.05	0.5	0.4	2"	50	7	140	10	240	5.5	12
50NEBS-6.10	1	0.75	2"	50	10	200	15	320	7	15

All technical information is subject to change without notice.

Dimensions

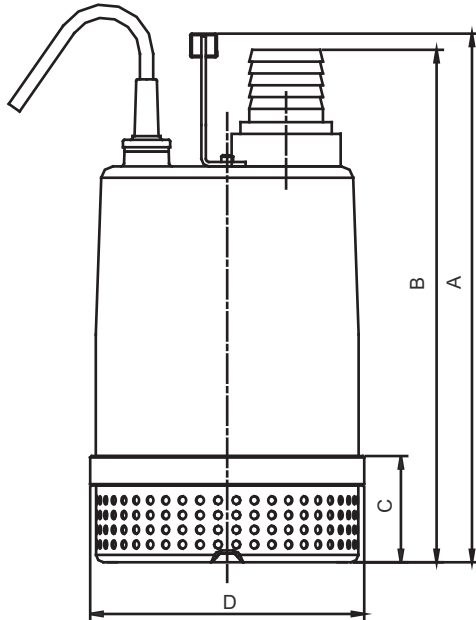

Type	A	B	C	D
50NEBS-6.05	360	355	72	184
50NEBS-6.10	360	355	72	184

Parts and Material list

No	Part	Material
1	Handle	SS-304
2	Switch plate	Cast Iron
3	Outer case	SS-304
4	Bearing bracket	SS-304
5	Seal bracket	SS-304
6	Shaft sleeve	SS-304
7	Impeller	SS-304
8	Cable	
9	Cable gland	NBR
10	Motor cover	SS-304

No	Part	Material
11	Thermal protector	
12	Bearing	
13	Stator	
14	Motor frame	SS-304
15	Shaft	SS-410
16	Bearing	
17	Mech. seal	
18	Oil seal	SS-304
19	Inlet plate	SS-304
20	Strainer	SS-304

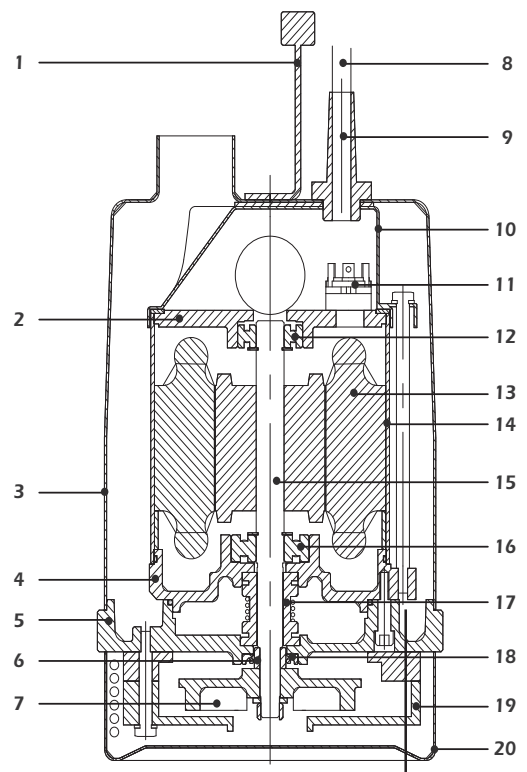

NE Series • Submersible Dewatering Pumps

Features

- High abrasive resistance resin Vortex impeller
- Double mechanical seal / Designed Agitator
- Auto reset thermal protector / Non air locking
- Auto version for small pit usage

Applications

- Residential, commercial, industrial dewatering and site drainage.
- Decorative waterfalls and fountains.
- Raw water supply from lakes or rivers.
- Sediment removal from small sumps of basins.



50NE-6.05

50(80)NE-6.10F

50NE-6.20

Performance Curves

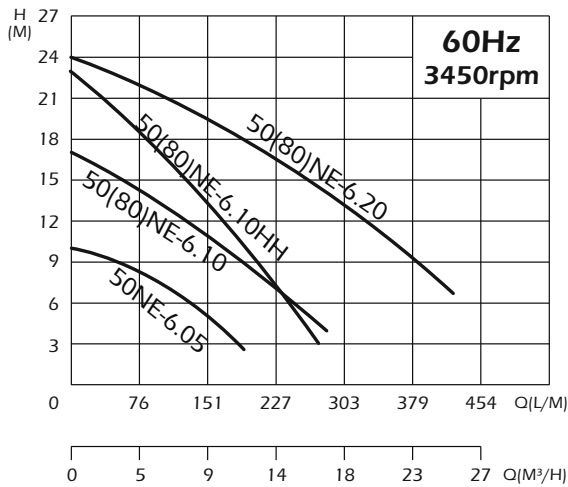

Agitator

Hytrell Impeller



Parts and Material list

No	Part	Material
1	Handle	Nylon 6
2	Motor Cover	ADC 12
4	End Bracket	SECC
5	Shaft	SS 410
6	Motor Housing	ADC 12
9	Mech. Seal	Upper : CA/CE Lower : SIC/SIC
10	Impeller	Hytrell
12	Pump Casing	Cast Iron
13	Agitator	SMF5030
16	Strainer	PVC

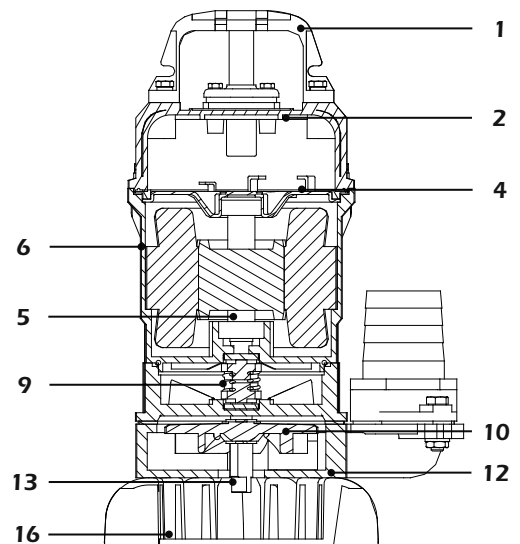

Specification

Type	Version	Output		Discharge		Rated		Maximum		Cable M	Weight Kg
		HP	W	mm	Inch	Head M	Capacity LPM	Head M	Capacity LPM		
50NE-6.05	Manual	0.5	400	50	2"	9	97	10	193	10	13
50NE-6.05A	Auto	0.5	400	50	2"	9	97	10	193	10	13.3
50(80)NE-6.10	Manual	1	750	50(80)	2"(3")	12	146	17	289	10	15.5
50(80)NE-6.10A	Auto	1	750	50(80)	2"(3")	12	146	17	289	10	15.8
50(80)NE-6.10HH	Manual	1	750	50(80)	2"(3")	16	117	23	306	10	15
50(80)NE-6.20	Manual	2	1500	50(80)	2"(3")	19	201	24	427	10	19.2
50(80)NE-6.20A	Auto	2	1500	50(80)	2"(3")	19	201	24	427	10	19.5

- > A: Automatic
- > Key or USA float switch are available to choose

Dimensions

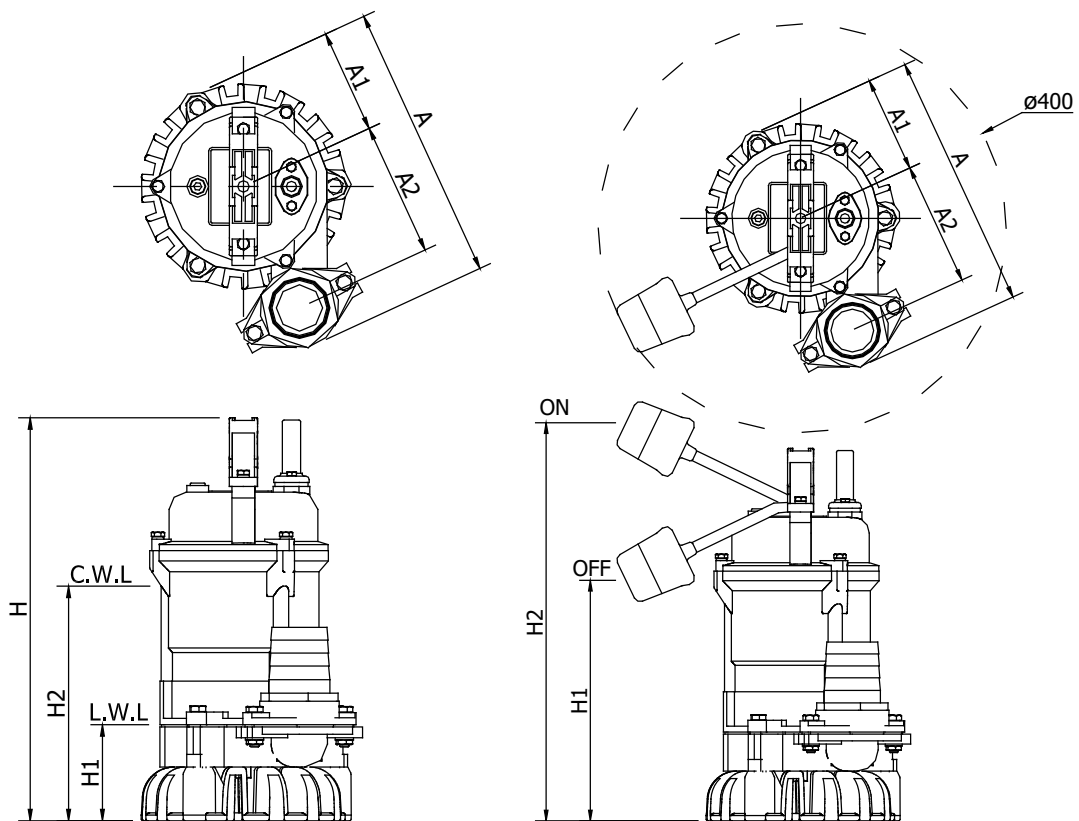

Type	Dimensions [mm]					
	A	A1	A2	H	H1	H2
50NE-6.05	243	94	117	352	84	200
50NE-6.05A	243	94	117	352	200	400
50(80)NE-6.10	279	94	133	377	84	225
50(80)NE-6.10A	279	94	133	377	225	425
50(80)NE-6.10HH	279	94	133	377	84	225
50(80)NE-6.20	313	107	155	446	94	308
50(80)NE-6.20A	313	107	155	446	294	494

NA • Submersible Dredging Pumps

Features

- Non-Clog operation.
- Double mechanical seal.
- Reliable shaft sealing.
- Vortex impeller with agitator.
- Automatic Operation (Optional).

Applications

- Dredging.
- High concentration slurry.



50NA-6.05



50(80)NA-6.20

Performance Curves

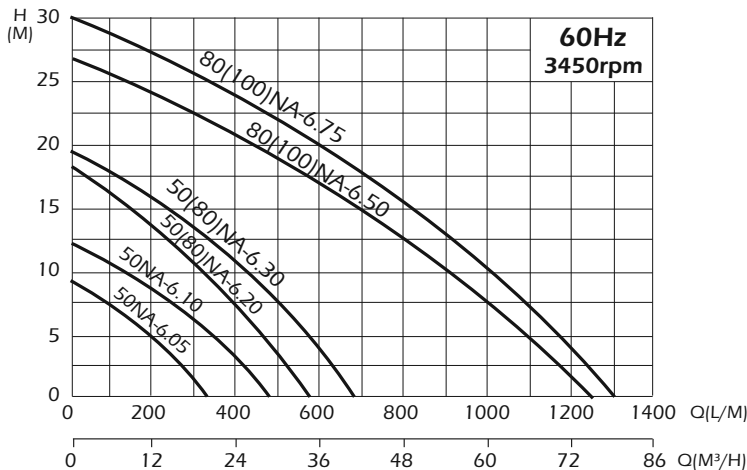

NA • Vortex Impeller
(with powerfull agitator)

Parts and Material list

No	Part	Material
1	Cable	H07
2	Cable Hood	NBR
9	Handle	Nylon 6/SS41
15	Motor Cover	Nylon 66/Cast iron
16	Seal Housing	Cast Iron
17	Bracket	Cast Iron
18	Oil Chamber	Cast Iron
20	Pump Casing	Cast Iron
21	Impeller	Cast Iron
24	Agitator	SS 316
25	Double Mech.Seal	Upper : CA / CE Lower : SIC / SIC
26	Oil Seal	NBR
52	Bearing	NTN
53	Protector	
54	Shaft	SS 410
65	Motor Housing	SS 304

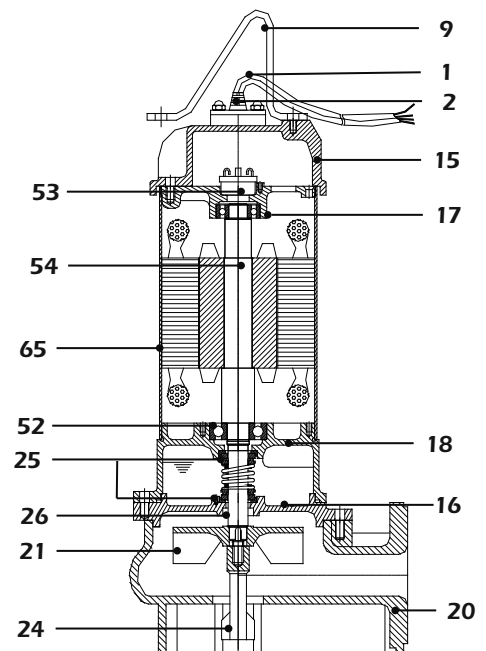

• All technical information is subject to change without notice.

Specifications

Model	Output		Discharge	Phase	Rated		Cable	Weight
	HP	kw			Inch	∅		
50NA-6.05	0.5	0.37	2"	1,3	6	180	5	13
50NA-6.10	1	0.75	2"	1,3	9	225	5	18
50(80)NA-6.20	2	1.5	2"(3")	1,3	11	300	5	33
50(80)NA-6.30	3	2.2	2"(3")	3	12	400	5	34
80(100)NA-6.50	5	3.7	3"(4")	3	17	570	10	56
80(100)NA-6.75	7.5	5.5	3"(4")	3	27	550	10	62

50NA-6.50 : Thread type / Flange type.

50NA-6.10 : Thread type / Flange type / Elbow type (2" or 3").

50(80)NA-6.20~30 : Elbow type (2" or 3").

80(100)NA-6.50~75 : Elbow type (3" or 4").

Dimensions

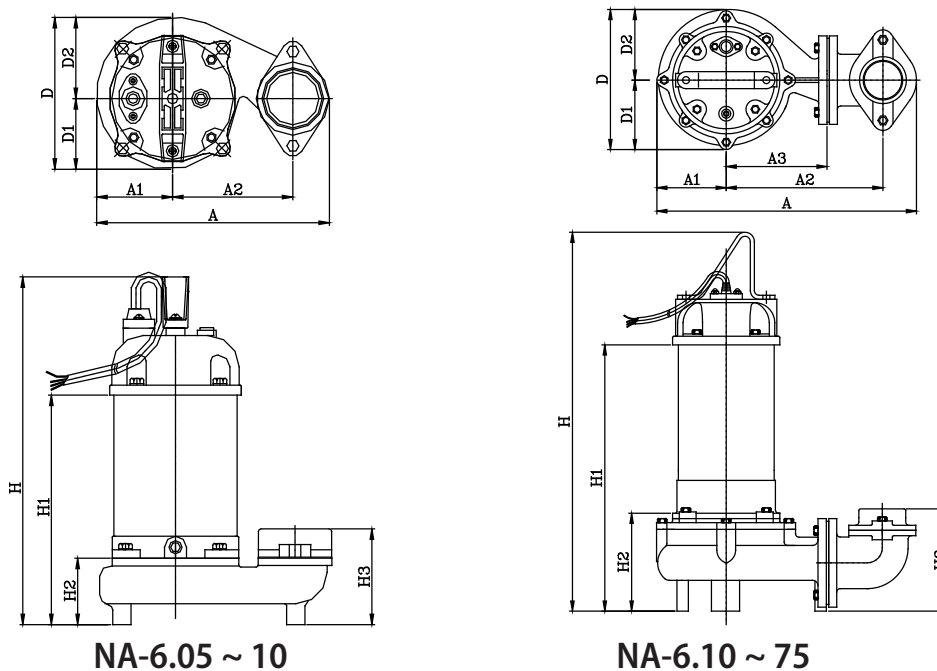

Type	A	A1	A2	A3	D	D1	D2	H	H1	H2	H3
50NA-6.05	228	73	155	NA	150	69	81	412	297	117	138
50NA-6.10	228	73	155	NA	150	69	81	487	345	117	138
*50(80)NA-6.10	312	82	183	101	163	76	87	494	351	124	156
50(80)NA-6.20	390	103	235	151	210	105	105	532	400	150	152
50(80)NA-6.30	390	103	235	151	210	105	105	532	420	150	152
80(100)NA-6.50	470	110	257	170	218	98	120	633	468	160	206
80(100)NA-6.75	470	110	257	170	218	98	120	673	508	160	206

- Automatic models are available in single-phase.
- Q.D.C (Quick Discharge Connection) is applied in all models.
- *50(80)NA-6.10 : Elbow type.

NC • Submersible Cutter Sewage Pumps

Features

- Double mechanical seal.
- Reliable shaft sealing.
- With tungsten cutter.
- Automatic Operation (Optional).

Applications

- Hospital, school, building.
- Wastewater treatment system.
- Industrial wastewater.
- Ground water drainage.



50NC-6.05



50(80)NC-6.20

Performance Curves

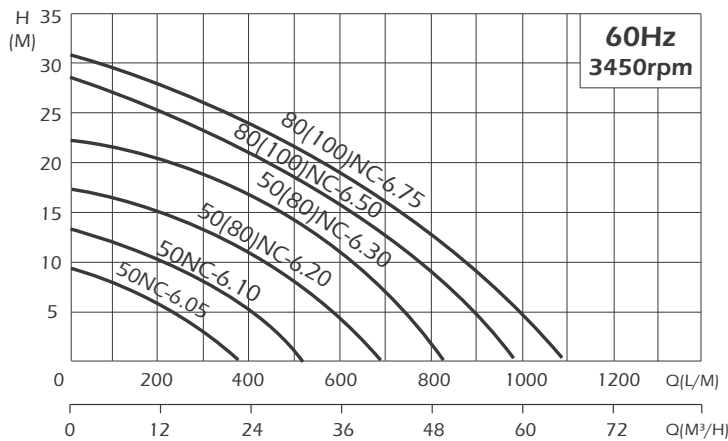

NC• Cutter Impeller
(Tungsten Edge)

Parts and Material list

No	Part	Material
1	Cable	H07
2	Cable hood	NBR
9	Handle	Nylon 6/SS41
15	Motor Cover	Nylon 66/Cast Iron
16	Seal Housing	Cast Iron
17	Bracket	Cast Iron
18	Oil Chamber	Cast Iron
20	Pump Casing	FCD 450/Cast Iron
21	Impeller	FCD 450
22	Strainer	FCD 450
25	Double Mech. Seal	Upper : CA / CE Lower : SIC / SIC
26	Oil Seal	NBR
41	Cutter edge	Tungsten
52	Bearing	NTN
53	Protector	
54	Shaft	SS 410
65	Motor Housing	SS 304

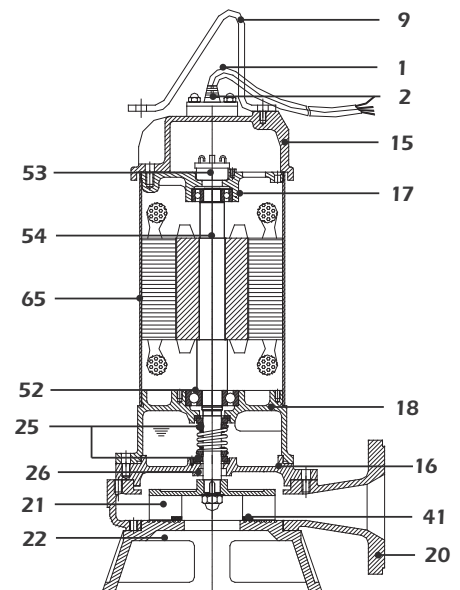

• All technical information is subject to change without notice.

Specifications

MODEL	Output		Discharge	Phase	Rated		Cable	Weight
	HP	kw			Head m	Capacity l/m		
50NC-6.05	0.5	0.37	2"	1,3	6	170	5	13
50NC-6.10	1	0.75	2"	1,3	8	250	5	18
50(80)NC-6.20	2	1.5	2"(3")	1,3	10	380	5	33
50(80)NC-6.30	3	2.2	2"(3")	3	13	500	5	34
80(100)NC-6.50	5	3.7	3"(4")	3	19	500	10	56
80(100)NC-6.75	7.5	5.5	3"(4")	3	26	730	10	62

- 50NC-6.50 : Thread type.
 50NC-6.10 : Thread type / Elbow type (2" or 3").
 50(80)NC-6.20~30 : Elbow type (2" or 3").
 80(100)NC-6.50~75 : Elbow type (3" or 4").

Dimensions

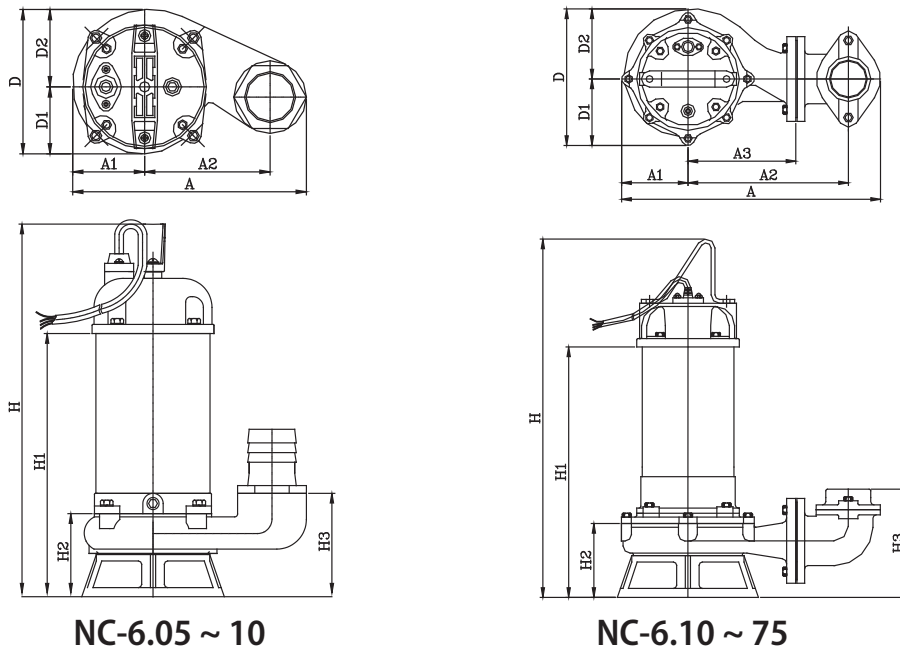

NC-6.05 ~ 10

NC-6.10 ~ 75

Model	A	A1	A2	A3	D	D1	D2	H	H1	H2	H3
50NC-6.05	253	95	158	NA	190	95	95	410	285	106	126
50NC-6.10	253	95	158	NA	190	95	95	480	333	106	126
*50(80)NC-6.10	265	95	199	115	190	95	95	402	290	104	164
50(80)NC-6.20	408	108	250	168	217	108	109	560	390	115	168
50(80)NC-6.30	408	108	250	168	217	108	109	580	410	115	168
80(100)NC-6.50	457	110	255	167	227	110	117	610	445	137	225
80(100)NC-6.75	457	110	255	167	227	110	117	650	485	137	225

- Automatic models are available in single-phase.
- Q.D.C (Quick Discharge Connection) is applied in all models.
- *50(80)NC-6.10 : Elbow type.

NW • Submersible Vortex Sewage Pumps

Features

- Non-Clog operation.
- Double mechanical seal.
- Vortex impeller with agitator.
- Large impeller clearance.
- Minimized abrasive wear.

Applications

- Medium concentration wastewater.
- Heavy duty.

Parts and Material list

No	Part	Material
1	Cable	H07 / UL
2	Handle	Nylon 6/SS41
3	Motor Cover	Nylon 66 / Cast iron
4	Bracket	Cast iron
5	Motor Housing	SS 304
6	Shaft with Rotor	SS 410
7	Oil Chamber	Cast iron
8	Double Mech.Seal	Upper : CA / CE Lower : SIC / SIC
9	Seal Housing	Cast iron
10	Oil Seal	NBR
11	Impeller	Cast iron
12	Pump Casing	Cast iron
13	Protector	
15	Bearing	NTN

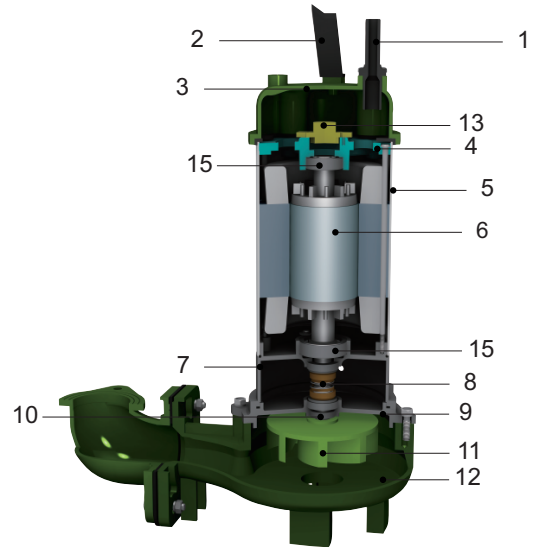

Performance Curves

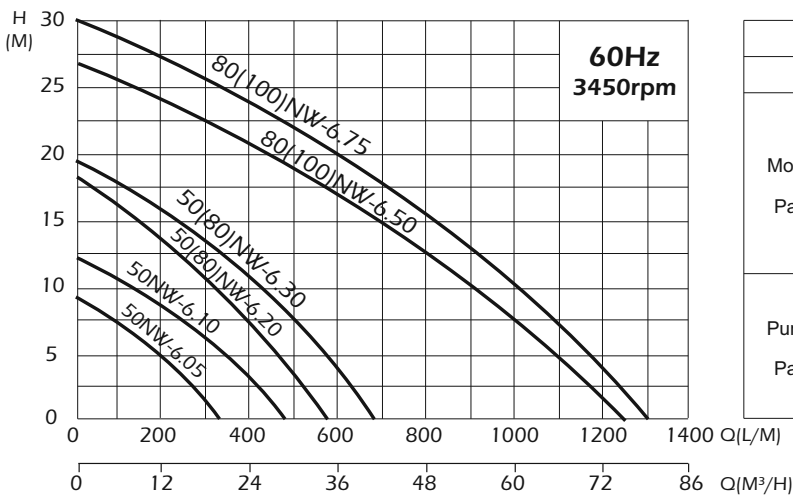

Liquid Temperature		0~40°C (32~104°F)
Submersible depth		10M
Motor	Frequency	50Hz
	Pole	2 Pole
	Type	Dry Motor
Part	Insulation	Class E
	Protection	IP 68
	Protector	Auto-cut
	Bearing	Ball Type
Pump	Mechanical seal	Dual. Mechanical Seal
	Impeller	Vortex

Model	Output		Discharge Inch	F.L.A.		Rated		Maximum		Cable M	Free Passage mm	Weight kg	Q.D.C.
	HP	KW		1ø 230V	3ø 400V	Head m	Cap. LPM	Head m	Cap. LPM				
50NW-6.05	0.5	0.37	2"	4	1.2	6	180	9.1	334	5	35	13	QS-50
50NW-6.10	1	0.75	2"	6	2	9	225	12	480	5	35	18	QS-50
50(80)NW-6.20	2	1.5	2"(3")	11.3	3.5	11	300	18	590	5	45	33	QM-80
50(80)NW-6.30	3	2.2	2"(3")	-	5.2	12	400	19.5	680	5	45	34	QM-80
80(100)NW-6.50	5	3.7	3"(4")	-	8.6	17	570	27	1250	10	45	56	QM-100
80(100)NW-6.75	7.5	5.5	3"(4")	-	12	26	550	20	1290	10	45	62	QM-100

- 50NW-6.05 : Flange type.
- 50NW-6.10 : Flange type / Elbow type (2" or 3" / Fit with Q.D.C. QM-80).
- 50(80)NW-6.20~30 : Elbow type.
- 80(100)NW-6.50~75 : Elbow type.

Dimensions

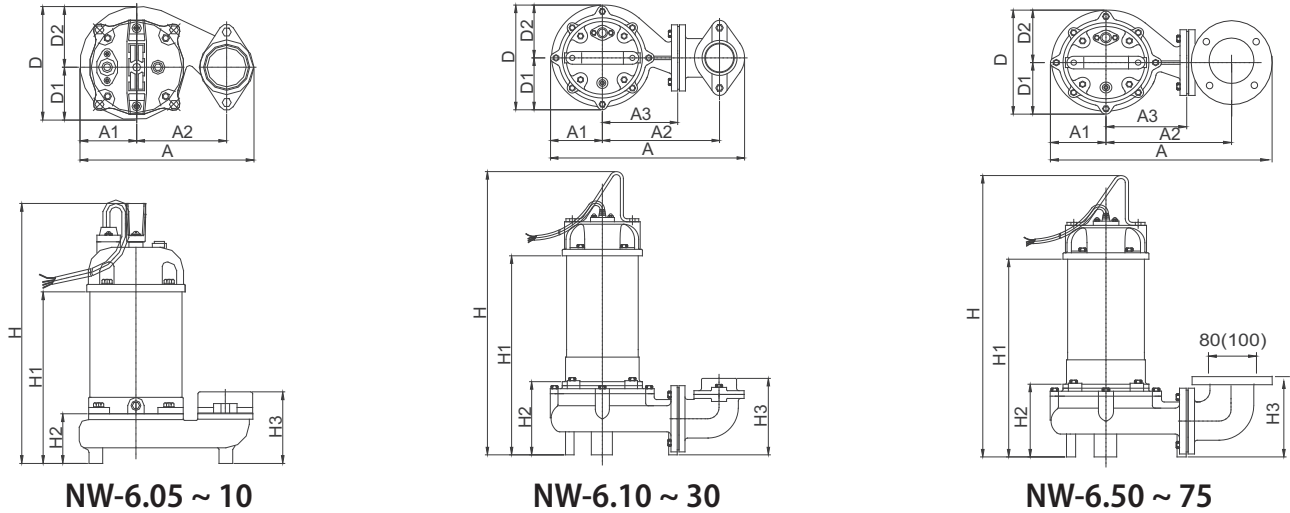

Model	Dimensions [mm]										
	A	A1	A2	A3	D	D1	D2	H	H1	H2	H3
50NW-6.05	228	73	155	N/A	150	69	81	412	297	117	138
50NW-6.10	228	73	155	N/A	150	69	81	487	345	117	138
*50(80)NW-6.10	312	82	183	101	163	76	87	494	351	124	156
50(80)NW-6.20	390	103	235	151	210	105	105	532	400	150	152
50(80)NW-6.30	390	103	235	151	210	105	105	552	420	150	152
80(100)NW-6.50	470	110	257	170	218	98	120	633	468	160	206
80(100)NW-6.75	470	110	257	170	218	98	120	673	508	160	206

- Automatic models are available in single-phase (0.5 ~ 1HP) and in three phase (0.5~2HP).
- Q.D.C (Quick Discharge Connection) is applied in all models.
- *50(80)NW-6.10 : Elbow type.

NW-Series with QS / QM

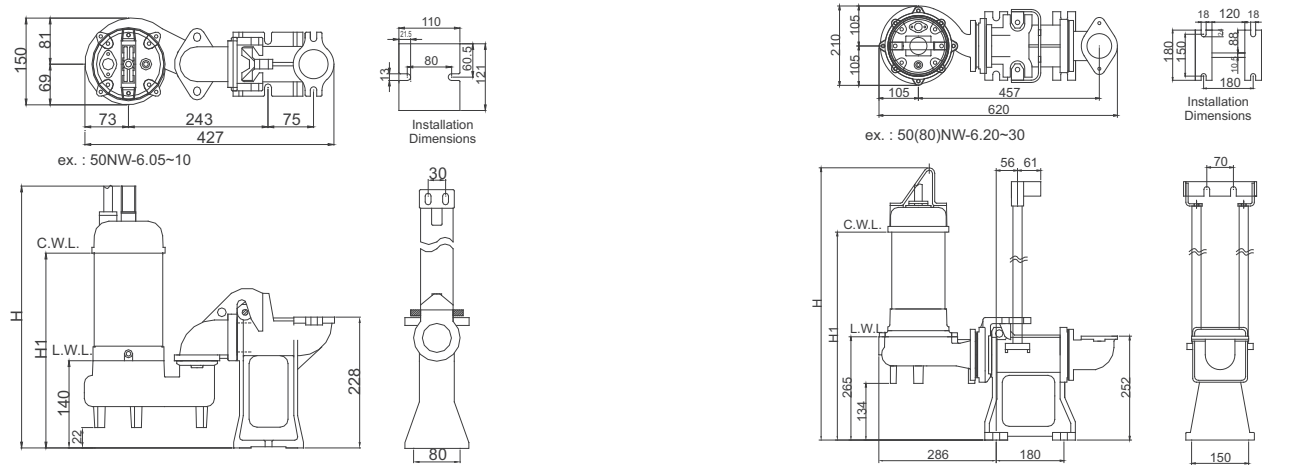

NW with QS Q.D.C					
Output		Discharge		Dimensions(mm)	
HP	KW	Inch	mm	H	H1
0.5	0.37	2"	50	434	319
1	0.75	2"	50	509	367

NW with QM Q.D.C					
Output		Discharge		Dimensions(mm)	
HP	KW	Inch	mm	H	H1
2	1.5	2"(3")	50(80)	715	545
3	2.2	2"(3")	50(80)	735	565
5	3.7	3"(4")	80(100)	775	597
7.5	5.5	3"(4")	80(100)	815	637

- All technical information is subject to change without notice.

GPK • Submersible Grinder Pumps

Features

- HRC 55-58 Grinder impeller.
- Robust construction.
- Superior heat dissipation.
- Duple mechanical seals (for 3HP / 5HP / 7.5HP).

Applications

- Waste water treatment.
- Sewage water.



32GPK-6.20

Performance Curves

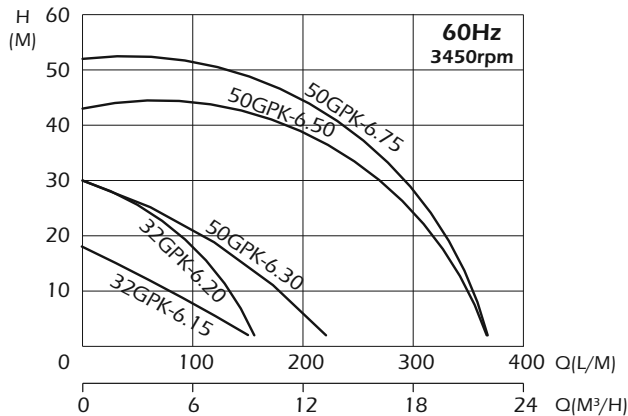

Grinder impeller and shredding ring

Specification

Type	Output		Discharge Inch	Phase Ø	Voltage V	FL. Amp A	Maximum		Cable M	Weight Kg
	HP	kw					Head M	Capacity LPM		
32GPK-6.15	1.5	1.1	1.25"	3,(1)	460(230)	5(16)	18	150	10	35
32GPK-6.20	2	1.5	1.25"	3,(1)	460(230)	5(16)	30	160	10	38
50GPK-6.30	3	2.2	2"	3	460	5	30	230	10	38
50GPK-6.50	5	3.7	2"	3	460	8.3	43	370	10	57
50GPK-6.75	7.5	5.5	2"	3	460	12.4	52	370	10	60

All technical information is subject to change without notice.

Dimensions

Type	32GPK-6.15	32GPK-6.20	50GPK-6.30	50GPK-6.50	50GPK-6.75
A	34	34	34	165	165
B	127.5	127.5	127.5	120	120
C	91.5	91.5	91.5	123	123
D	96	96	96	115.5	115.5
E	82	92	92	285	285
F	253	253	253	177.8	177.8
G	90	90	90	139.7	139.7
H	474	425	425	631	631
K	126	126	126	100	100

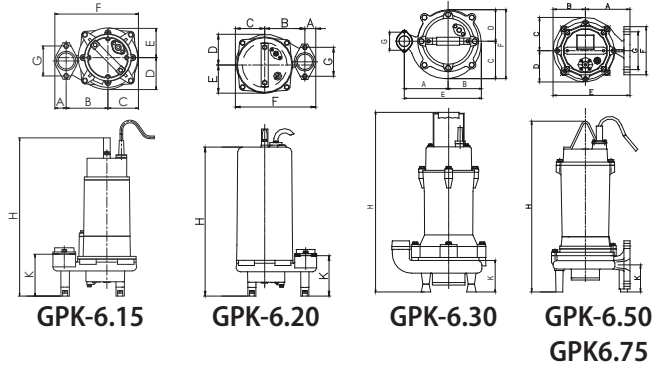

GPK-6.20~30 • Parts and Material list

No	Part	Material
2	Handle	SS-304
3	Switch Plate	SC _(2HP) /Cast Iron _(3HP)
4	Upper Cover	Cast Iron
7a	Shredder Ring	High Chrome Steel
7b	Shredder Cutter	High Chrome Steel
7c	Shredder Ring Bracket	Cast Iron
10	Pump Casing	Cast Iron
11	Seal Bracket	Cast Iron
15	Impeller	Cast Iron
17	Motor Frame	SC _(2HP) /Cast Iron _(3HP)
19	Bearing Bracket	Cast Iron
31	Stator	
32	Rotor / Shaft	
43	Mech. Seal (3HP)	Upper : CA/CE Lower : SIC/SIC
43a	Mech. Seal (2HP)	SIC/SIC
66	Cable Gland	NBR
67	Shaft Sleeve	SS-304(3HP)

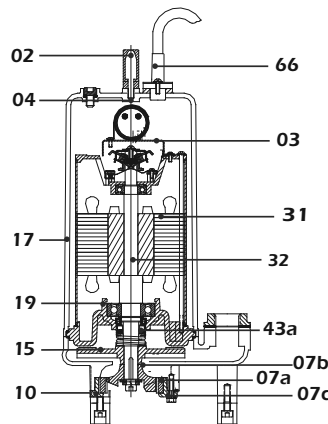

32GPK-6.20

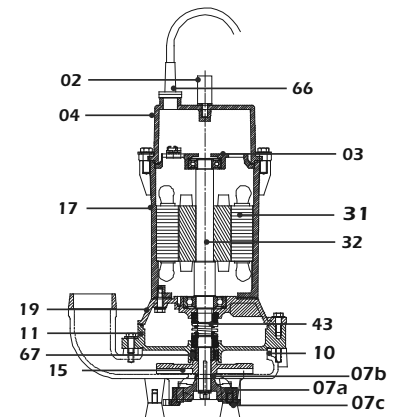

50GPK-6.30

GPK-6.50~75 • Parts and Material list

No	Part	Material
2	Handle	FCD-45
3	Switch Plate	Cast Iron
4	Upper Cover	Cast Iron
7a	Shredder Ring	High Chrome Steel
7b	Shredder Cutter	High Chrome Steel
7c	Shredder Ring Bracket	Cast Iron
10	Pump Casing	Cast Iron
11	Seal Bracket	Cast Iron
15	impeller	Cast Iron
17	Motor Frame	Cast Iron
19	Bearing Bracket	Cast Iron
31	Stator	
32	Rotor / Shaft	
43	Mechanical Seal	CA / CE
43a	Mechanical Seal	SIC / SIC
66	Cable Gland	NBR
68	Gland Holder	SS-304

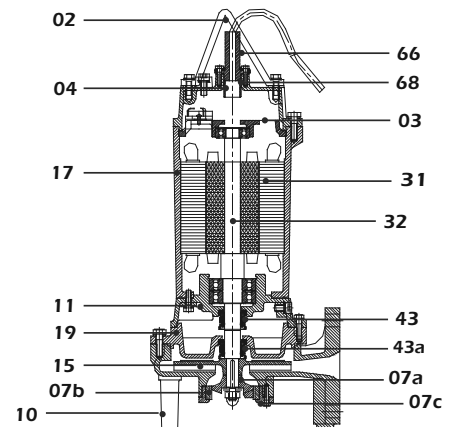

50GPK-6.50 • 50GPK-6.75

NSA • Submersible Heavy-Duty Slurry Pumps

Features

- Semi-open, Ductile impeller.
- Double mechanical seal with silicon carbide faces.
- Highly efficient.
- Built in thermal and amperage sensing.
- Double shielded.
- Top discharge.

Applications

- Mill scale / Lime slurries.
- Coal runoff sumps / Wash down sumps.
- Ash transfer / Tailings ponds.
- Slag pits / Food Wastes / Silt removal.
- Sand & gravel dewatering / Barge & tank cleanout.



NSA-6.150



NSA-6.75

Performance Curves

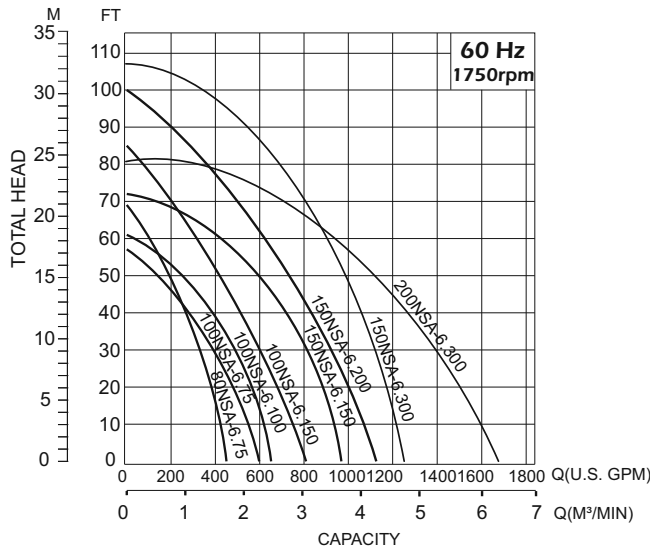

Semi-open Impeller
(with agitator)

Specifications

Model	Output		Power		Max solids mm	Discharge Inch	Maximum		Weight Kg
	HP	KW	Voltage V	Rated AMPS			Head M	Capacity LPM	
80NSA-6.75	7.5	5.5	230/460	21.5/10.8	25	3"	21	1700	123
100NSA-6.75	7.5	5.5	230/460	21.5/10.8	25	4"	17.5	2250	124
100NSA-6.100	10	7.5	230/460	28.7/14.3	25	4"	18.5	2480	124
100NSA-6.150	15	11	230/460	43/21.5	25	4"	26	3100	191
150NSA-6.150	15	11	230/460	43/21.5	35	6"	22	3700	192
150NSA-6.200	20	15	230/460	57.4/28.7	35	6"	30.5	4300	201
150NSA-6.300	30	22	230/460	86.1/43	30	6"	32	4800	357
200NSA-6.300	30	22	230/460	86.1/43	38	8"	24	6300	358

Dimensions

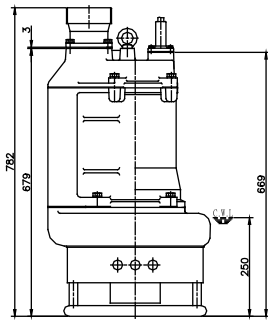
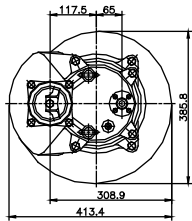

NSA-6.75~100

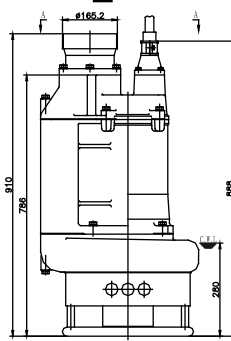
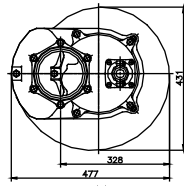

NSA-6.150~200

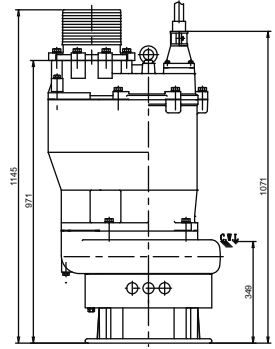
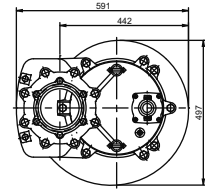

NSA-6.300

> C.W.L. : Continuously Running Water Level

Parts and material list

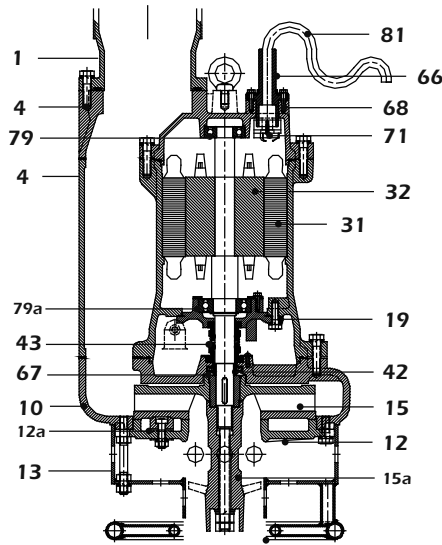

NSA-6.75~100 Part and Material List

No.	Part	Material
1	Discharge head	Cast iron
4	Upper cover	Cast iron
10	Pump casing	Cast iron
12	Inlet plate	Cast iron
12a	Wear plate	High chrome steel
13	Strainer	SC
15	Impeller	High chrome steel
15a	Agitator	High chrome steel
17	Motor frame	Cast iron
19	Bearing bracket	Cast iron
31	Stator	
32	Shaft / Rotor	SS-410
42	Oil seal	NBR
43	Mech. seal	
66	Cable gland	NBR
67	Shaft sleeve	SS-410
68	Gland holder	SS-304
71	Thermal protector	
79	Bearing	
79a	Bearing	
81	Cable	

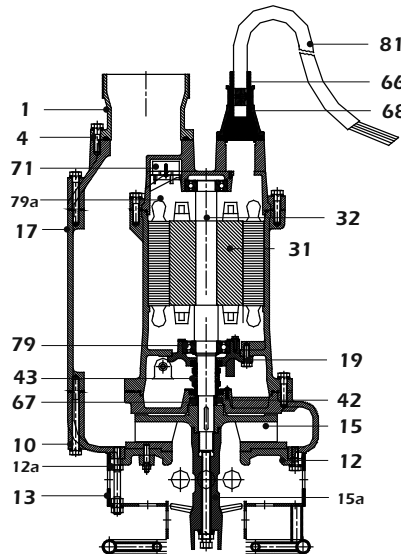

NSA-6.150~200 Part and Material List

No.	Part	Material
1	Discharge head	Cast iron
4	Upper cover	Cast iron
10	Pump casing	Cast iron
12	Inlet plate	Cast iron
12a	Wear plate	High chrome steel
13	Strainer	SC
15	Impeller	High chrome steel
15a	Agitator	High chrome steel
17	Motor frame	Cast iron
19	Bearing bracket	Cast iron
31	Stator	
32	Shaft / Rotor	SS-410
42	Oil seal	NBR
43	Mech. seal	
66	Cable gland	NBR
67	Shaft sleeve	SS-410
68	Gland holder	Cast iron
71	Thermal protector	
79	Bearing	
79a	Bearing	
81	Cable	

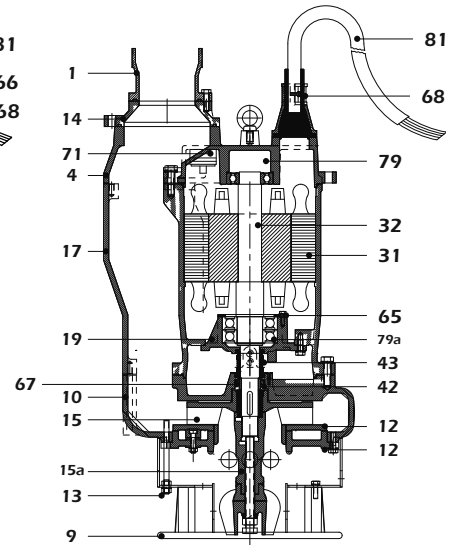

NSA-6.300 Part and Material List

No.	Part	Material
1	Discharge head	Cast iron
4	Upper cover	Cast iron
9	Base plate	Cast iron
10	Pump casing	Cast iron
12	Inlet plate	Cast iron
12a	Wear plate	HCR
13	Strainer	SC
14	Flang	Cast iron
15	Impeller	HCR
15a	Agitator	HCR
17	Motor frame	Cast iron
19	Bearing bracket	Cast iron
31	Stator	
32	Shaft / Rotor without bearing	SS-410
42	Oil seal	NBR
43	Mech. seal	
65	Shim	SS-400
67	Shaft sleeve	SS-410
68	Gland holder	Cast iron
71	Thermal protector	
79	Bearing	
79a	Bearing	
81	Cable	

MAM • Submersible Sewage Pumps

Features

- Non-clog single channel impeller.
- Robust construction.
- Large solid passage.
- Dry tip (Optional).

Applications

- Sewage
- Waste water



80MAM-6.100



MAM-Series Impeller
(Enclosed single channel)

Performance Curves

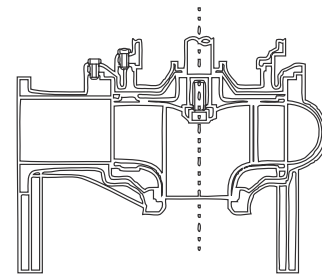
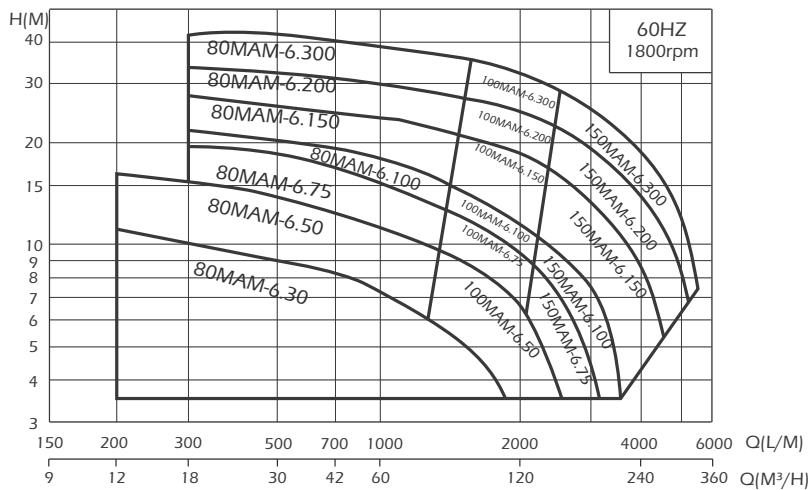

MAM-Series
Impeller Type & Solids Handling

Parts and Material list

No	Part	Material
1	Submersible Cable	
2	Lifting Hanger	SS Steel
3	Thermal Protector	
4	Ball Bearing	
5	Impeller	Cast iron
6	Impeller Bolt	SS-304
7	Opposite Side Bracket	Cast iron
8	Rotor	
9	Stator	
10	Shaft	SS-403
11	Motor Frame	Cast iron
12	Power Side Bracket	Cast iron
13	Mechanical Seal	Upper : CA/CE Lower : SIC/SIC
14	Mechanical Seal Cover	Cast iron
15	Pump Casing	Cast iron

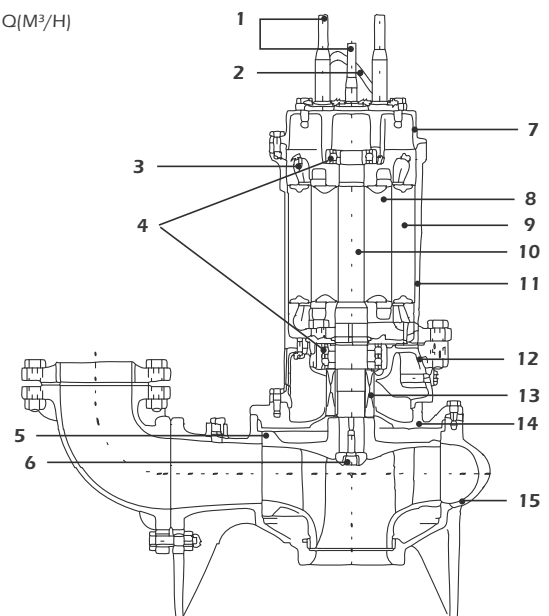

All technical information is subject to change without notice.

Specifications

Model	Output HP	Discharge Inch	Phase Ø	Q LPM	Max Head M	Q LPM	Rate Head M	Weight Kg
80MAM-6.30	3	3"	3	200	10.9	1777	3.5	75
80MAM-6.50	5	3"	3	200	16.7	1330	9.5	82
80MAM-6.75	7.5	3"	3	300	19.7	1384	12.6	104
80MAM-6.100	10	3"	3	300	23	1418	15	109
80MAM-6.150	15	3"	3	300	28.4	1484	21	152
80MAM-6.200	20	3"	3	300	34.5	1528	26.1	158
80MAM-6.300	30	3"	3	300	41.6	1590	35.3	209
100MAM-6.50	5	4"	3	1330	9.5	2513	3.5	84
100MAM-6.75	7.5	4"	3	1384	12.6	2217	8.5	107
100MAM-6.100	10	4"	3	1418	15	2280	10.8	111
100MAM-6.150	15	4"	3	1484	21	2405	16.1	154
100MAM-6.200	20	4"	3	1528	26.1	2493	21.2	160
100MAM-6.300	30	4"	3	1590	35.3	2580	28.3	211
150MAM-6.75	7.5	6"	3	2217	8.5	3186	3.5	113
150MAM-6.100	10	6"	3	2280	10.8	3627	3.5	118
150MAM-6.150	15	6"	3	2405	16.1	4274	5.5	161
150MAM-6.200	20	6"	3	2493	21.3	4800	7.7	167
150MAM-6.300	30	6"	3	2580	28.3	5175	9.5	218

Dimensions

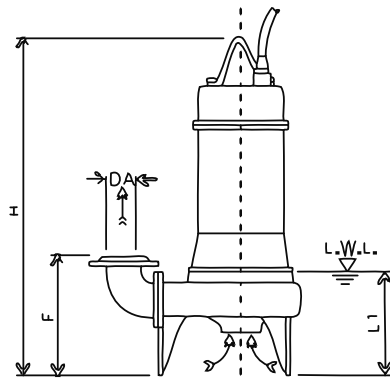

1. L.W.L(Low Water Level)
Is limited to 10 minutes
operation at low water level

2. Is limited to 30minutes operation
with water level below top of motor

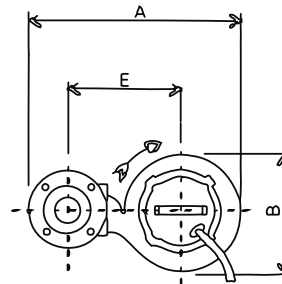

Model	Dimensions [mm]					
	A	B	E	F	H	L1
80MAM-6.30	512	295	275	296	666	277
80MAM-6.50	512	295	275	296	725	277
80MAM-6.75	587	325	335	311	805	292
80MAM-6.100	587	325	335	311	805	292
80MAM-6.150	656	393	370	332	929	320
80MAM-6.200	656	393	370	332	929	320
80MAM-6.300	734	455	420	350	1008	329
100MAM-6.50	554	295	305	311	725	277
100MAM-6.75	599	325	335	311	805	292
100MAM-6.100	599	325	335	311	805	292
100MAM-6.150	669	393	370	332	929	320
100MAM-6.200	669	393	370	332	929	320
100MAM-6.300	746	455	420	350	1008	329
150MAM-6.75	659	325	360	346	805	292
150MAM-6.100	659	325	360	346	805	292
150MAM-6.150	729	393	395	367	929	320
150MAM-6.200	729	393	395	367	929	320
150MAM-6.300	806	455	445	385	1008	329

MAL • Submersible Sewage Pumps

Features

- Semi- Open Impeller
- Non-Clogging/Wide Rang
- Robust construction
- Superior heat Dissipation
- Built-in motor protection

Applications

- Sewage / Waste water.
- Strom water drainage.



80(100)MAL-6.100

MAL-Series Impeller
(Non-clog type)

Performance Curves

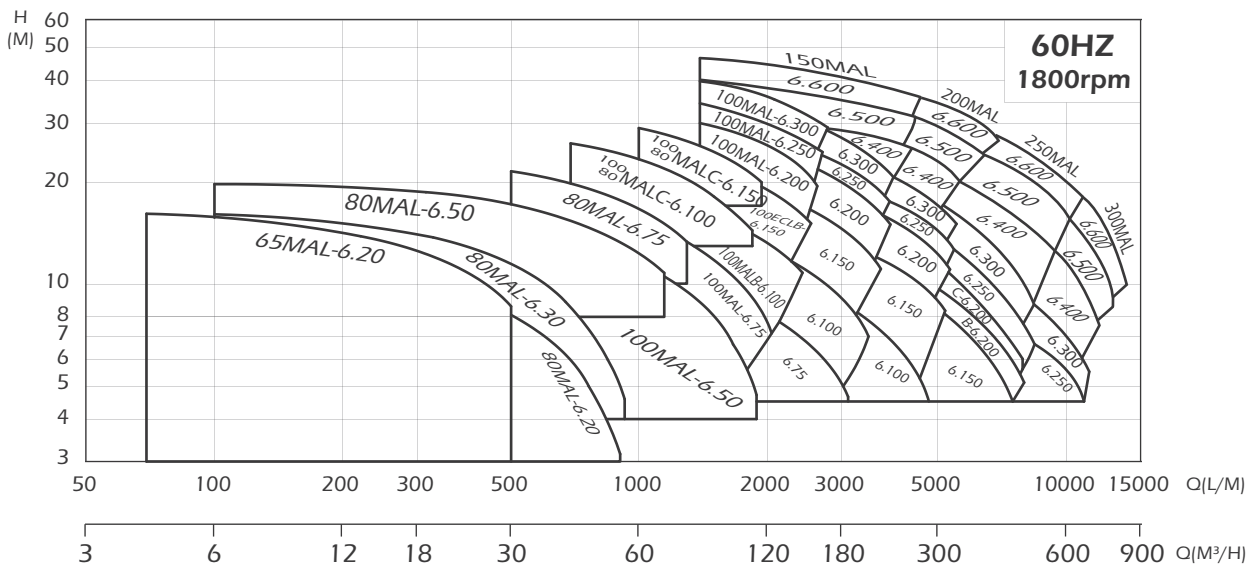

Parts and Material list

No	Part	Material
1	Submersible Cable	
2	Lifting Hanger	SS Steel
3	Protector	
4	Ball Bearing	
5	Impeller	Cast Iron
6	Impeller Bolt	SS-304
7	Opposite Side Bracket	Cast Iron
8	Rotor	
9	Stator	
10	Shaft	SS-403
11	Motor Frame	Cast Iron
12	Power Side Bracket	Cast Iron
13	Mechanical Seal	Upper : CA/CE Lower : SIC/SIC
14	Mechanical Seal Cover	Cast Iron
15	Pump Casing	Cast Iron

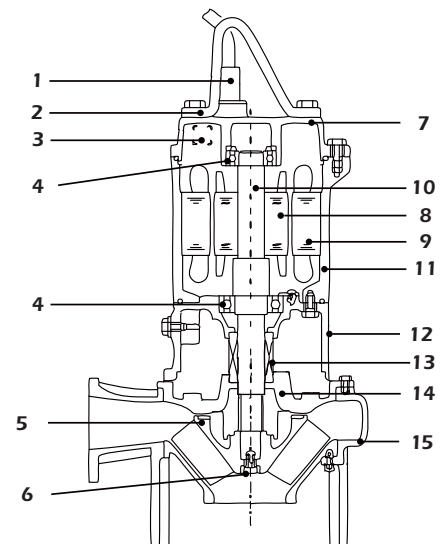

Dimensions

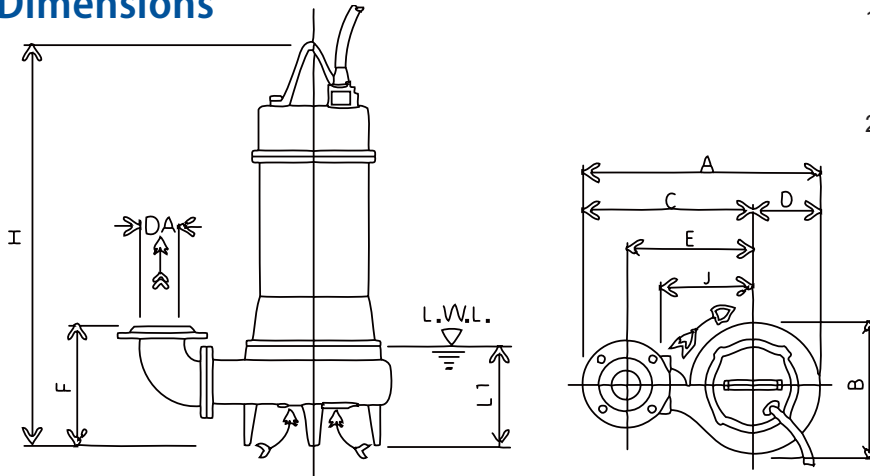

1. L.W.L (Low Water Level) Is limited to 10 minutes operation at low water level
2. Is limited to 30 minutes operation with water level below top of motor

Model	Output HP	Q LPM	Max Head M	Max Q LPM	Head M	Dimensions (mm)											Weight kg
						A	B	C	D	E	F	H	J	L1			
65MAL-5.20	2	70	15.5	450	9.9	497	291	353	144	265	200	576	200	140	52		
80MAL-5.20	2	200	12.2	950	3.3	524	292	378	146	285	220	597	210	165	55		
80MAL-5.30	3	100	15.8	1200	4	542	308	388	154	295	220	654	220	165	67		
80MAL-5.50	5	100	19.1	1200	10.4	567	328	403	164	310	220	687	235	165	75		
80MALC-5.75	7.5	200	22	1600	12.3	618	379	428	190	335	307	753	260	205	134		
80MALC-5.100	10	200	27.3	1800	15.3	648	399	448	200	355	305	751	280	205	148		
100MAL-5.50	5	500	14	1900	5	614	335	445	169	340	250	706	235	185	79		
100MALC-5.75	7.5	200	22	1600	12.3	660	379	470	190	365	322	753	260	205	134		
100MALC-5.100	10	200	27.3	1800	15.3	690	399	490	200	385	320	751	280	205	148		
100MALB-5.75	7.5	500	16.1	2290	8.3	646	369	460	186	355	323	768	250	205	123		
100MALB-5.100	10	500	20.8	2300	11.5	673	385	480	193	375	323	760	270	205	141		
100MAL-5.150	15	500	28.4	2500	16	701	402	500	201	395	323	859	290	205	180		
100MAL-5.200	20	500	33	2600	20.6	741	441	520	221	415	330	954	310	205	230		
100MAL-5.250	25	500	39	2600	24	741	441	520	221	415	330	958	310	205	285		
150MAL-5.75	7.5	1500	11.2	3050	5.8	750	398	550	200	410	381	799	280	245	146		
150MAL-5.100	10	1500	15.2	3300	8.3	780	418	570	210	430	377	784	300	245	158		
150MAL-5.150	15	1500	20	3600	11.5	810	438	590	220	450	377	833	320	245	199		
150MAL-5.200	20	1500	25.8	3700	15.2	810	438	590	220	450	377	972	320	245	237		
150MAL-5.250	25	1500	28.3	3800	18	848	476	610	238	470	381	979	340	245	300		
150MAL-5.300	30	1500	33	4000	20.5	848	476	610	238	470	381	979	340	245	325		
150MAL-5.400	40	1500	35	4000	27.4	912	520	650	262	510	468	1284	360	1080	355		
150MAL-5.500	50	1500	38.6	4100	30.4	912	520	650	262	510	468	1434	360	1165	418		
150MAL-5.600	60	1000	44	4300	34.8	912	520	650	262	510	468	1434	360	1165	456		
200MAL-5.75	7.5	2600	6.5	3800	4	832	430	615	217	450	414	826	300	285	160		
200MAL-5.100	10	2900	9.6	4700	5.8	863	453	635	228	470	410	809	320	285	176		
200MAL-5.150	15	3100	13.2	5000	9	863	453	635	228	470	410	908	320	285	212		
200MAL-5.200	20	3400	17	5300	12	896	479	635	241	490	411	995	340	285	260		
200MAL-5.250	25	3500	19.4	5300	13.5	932	512	675	257	510	415	1001	360	285	305		
200MAL-5.300	30	3500	23.2	5500	15	932	512	675	257	510	415	1001	360	285	330		
200MAL-5.400	40	4000	27.4	6200	20.5	937	520	675	262	510	483	1284	360	1080	355		
200MAL-5.500	50	4100	30.4	6500	23	937	520	675	262	510	483	1434	360	1165	418		
200MAL-5.600	60	4300	34.8	7000	26.5	937	520	675	262	510	483	1434	360	1165	456		
250MAL-5.100	10	3800	7.2	5850	4	969	525	700	269	500	622	904	370	400	260		
250MAL-5.150	15	4600	10.4	7100	4.8	993	541	720	273	520	634	1000	390	400	320		
250MAL-5.200	20	4500	13	7250	6.4	1007	549	730	277	530	646	1086	400	400	380		
250MAL-5.250	25	4500	15.7	7500	7.3	1007	549	730	277	530	646	1089	400	400	420		
250MAL-5.300	30	4500	17.2	8000	8.2	1007	549	730	277	530	646	1089	400	400	440		
250MAL-5.400	40	6300	21	9300	12.2	1125	660	790	335	590	706	1336	460	1132	458		
250MAL-5.500	50	6800	24.9	10200	15.8	1125	660	790	335	590	706	1505	460	1236	522		
250MAL-5.600	60	7500	27.2	10700	18	1125	660	790	335	590	706	1505	460	1236	540		
300MAL-5.150	15	6000	5.5	8300	4	1100	588	798	302	575	671	1050	420	450	365		
300MAL-5.200	20	6000	8	10700	4.4	1100	588	798	302	575	671	1131	420	450	395		
300MAL-5.250	25	6300	9.5	11000	4.8	1135	618	818	317	595	668	1131	440	450	440		
300MAL-5.300	30	6500	11.9	12000	6.4	1135	618	818	317	595	668	1131	440	450	465		
300MAL-5.400	40	9300	12.2	10800	7.8	1172	660	838	335	615	726	1336	460	1132	458		
300MAL-5.500	50	10200	15.8	12600	7.7	1172	660	838	335	615	726	1505	460	1236	522		
300MAL-5.600	60	10700	18	13200	9	1172	660	838	335	615	726	1505	460	1236	540		

All technical information is subject to change without notice.

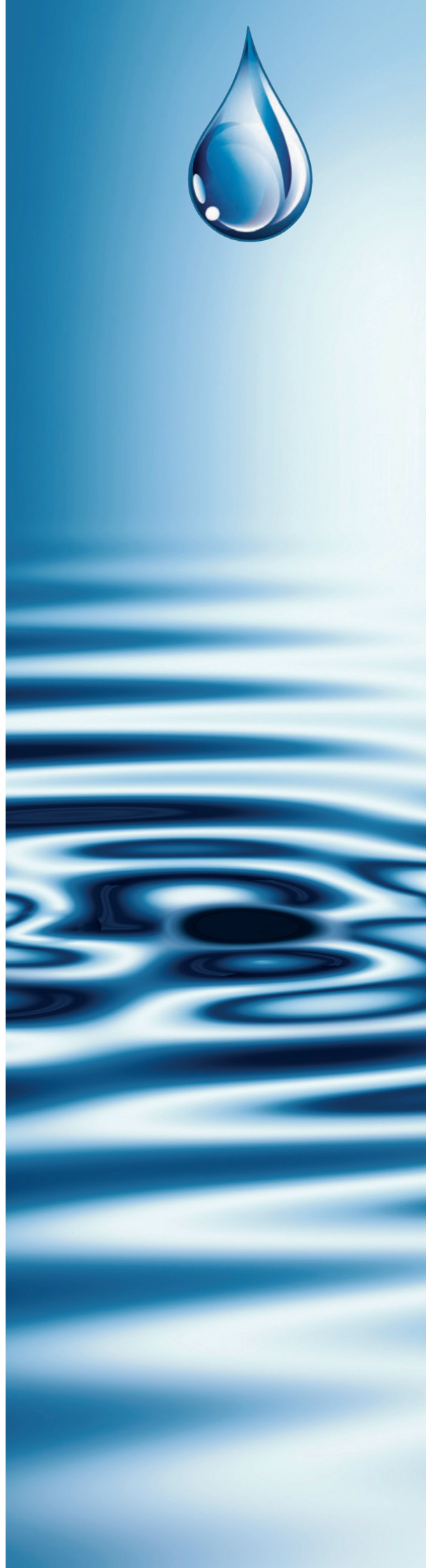



Swiss Pump Company AG
Moosweg 36
CH - 3645 Thun - Gwatt
Switzerland
Tel. +41 33 223 11 00
Fax +41 33 223 11 22
mail@swisspump.com

www.swisspump.com